



A2D-TOY03

BLUETOOTH MUSIC STREAMING INSTALLATION GUIDE FOR SELECT TOYOTA, LEXUS & SCION

Created January 15, 2015
Revised January 4, 2023

PRODUCT SAFETY & DISCLAIMER

READ ALL INSTRUCTIONS CAREFULLY BEFORE INSTALLING, FAILURE TO DO SO MAY CAUSE PERSONAL INJURY OR DAMAGE TO PRODUCT AND/OR PROPERTY

- This installation guide is provided as a GENERAL installation guide, some vehicles vary and may require additional steps. We do not accept responsibility for third party labor charges or modifications. Exercise due-diligence when installing this product.
- We do not accept any responsibility for vehicle damage or personal injury resulting from the installation of this product.
- Careless installation and operation can result in equipment damage.

Requirements:

CD CHANGER CONTROLLING RADIO

Introduction:

Just because you drive an older car does not mean you settle for old technology. The A2D-TOY03 updates select 2003-12 Toyota/Lexus/Scion radios to support music streaming connection from Smartphone, Tablet, Kindle and more.

The A2D-TOY03 has the option to retain SiriusXM (if subscribed) or a remote CD changer or both. The module connects to the radio 12-pin socket and after a short pairing session, users are able to enjoy the best sound possible on the car speakers!

See **Frequently Asked question** at the end of this guide for more details.

Installation:

1. Remove Toyota radio from dashboard to gain access to the connectors. (Vehicle specific radio removal instructions are not part of this guide, but available upon request)
2. Locate 12-pin radio socket (See **Fig. 2**). If socket is empty, simply plug-in the module 12-pin plug (See **Fig. 1**) and **proceed to "Pairing" section on page 3.**

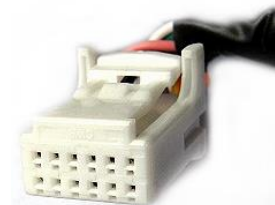

Fig. 1
12-pin plug



Fig. 2
Radio 12-pin connector

3. If vehicle has XM module or remote CD changer; disconnect 12-pin plug (See **Fig. 1**) from radio and connect to 12-pin socket on module harness.
4. Connect module harness 12-pin plug to radio socket vacated in step 3.
5. Proceed to pairing.

Pairing:

The pairing process varies among devices but the basic steps are the same. Pairing is done upon initial install and will not have to be repeated.

1. Go to device **Settings, Wireless & Networks, Bluetooth Settings**
2. Select **Bluetooth** and turn on.
3. Tap "**Scan**" or "**Search**" for devices.
4. Wait for the Bluetooth device name to appear and select it. (See **Fig. 3**- not retaining factory option or **Fig4**- retaining factory option)

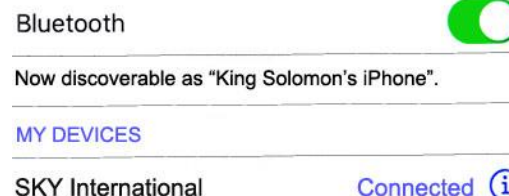

Fig. 3

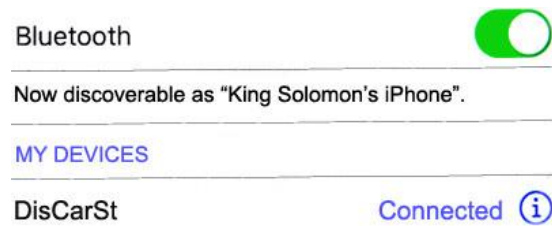

Fig. 4

Optional smart remote:

Smart remote is not required for module to work as described; however instead of fumbling audio device to change tracks etc., you simply press the familiar control buttons while also keeping eyes on the road.

Optional remote control allows users to:

1. Control music wirelessly
2. Activate VR commands (Google play only.)
3. Track up/down
4. Volume up/down

Pairing:

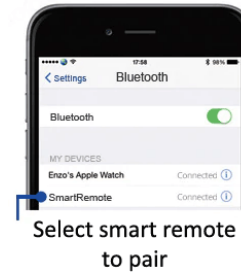

Remote operation:

Use remote to perform the following functions on any iOS7.0 and higher or Android 4.4 and higher.

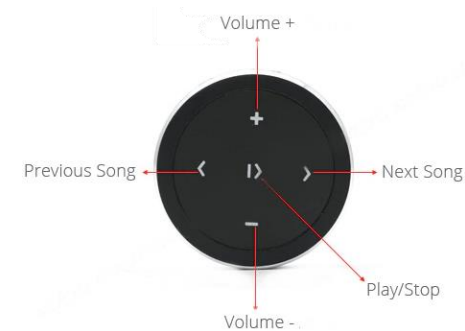

Contents:

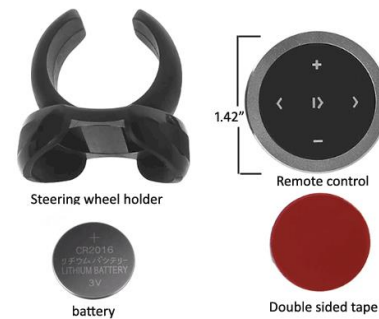

Operation:

1. Turn ignition and radio "ON"
2. Press "CD", "CD-AUX", "SAT" or "XM" button to enter external device mode (See Fig. 5)



Fig. 5

3. Launch smartphone or tablet streaming application.
4. Smartphone volume should be 85% or higher.
5. Use radio volume control button to set playback level.

Warning: Playlist and Track selection, text display are *NOT* possible from radio. Use audio device built-in controls or optional wireless remote to access and control audio files.

To listen to XM (Subscribers only) or remote CD changer

- a. Press "CD", "CD-AUX", "SAT" or "XM", "AM-SAT" button on radio to enter external device mode.
 - b. Disable Bluetooth on device. XM or CD changer playback resumes. (Control XM/changer from radio buttons as customary)
2. To return to streaming:

Enable Bluetooth on A2DP device settings screen.

Note: Streaming has priority and remains until Bluetooth is disabled on A2DP device. XM/CD changer playback is possible when smart device is no longer paired or device is out of range.

This concludes the installation of the A2D-TOY03. Enjoy!!!

Frequent asked questions & troubleshooting:

1. Will the A2D-TOY03 work in vehicles with a 6-CD changer radio? (Changer built-into AM/FM radio)
YES; the changer built-into radio will continue to work.
2. Can I use the A2D-TOY03 to make hands-free calls?
NO; The A2D-TOY03 support music streaming but **does not** support hands-free-calls.
3. Will I have to disconnect Satellite radio or separate (external) CD changer?
NO. Any External device (CD changer, XM radio, rear DVD etc.) remains connected and functional. When ordering, please select applicable option from drop-down menu.
4. My vehicle has a SiriusXM module, but subscription has expired (Only able to tune preview channel), will the A2D-TOY03 still work?
YES. The A2D-TOY03 works even if subscription has expired. Please select applicable option from drop-down.

* External or remote CD changer refers to option installed in lower dash, armrest, hatch, trunk etc. **CD changer built-into AM/FM radio is internal not external and remains functional.**

Email support@discountcarstereo.com

© 1995-January 23 Discount Car Stereo. All rights reserved. Information in this document is subject to change without notice. Other products and companies referred to herein are trademarks or registered trademarks of their respective companies or mark holders.