



# A2D-CHRY

**QUICK START MUSIC STREAMING, CHANGER RETENTION INSTALLATION GUIDE FOR SELECT 1995-02 CHRYSLER**

Created February 6, 2017  
Revised: October 16, 2020

## Introduction:

Portable audio products are everywhere, reflecting demand from active people all over the world to take their music on the road. The AZD-CHRY module provides **Bluetooth music streaming** solution for any AZDP enabled Smartphone or Tablet for select 1995-02 Chrysler with optional CD changer. This Bluetooth receiver allows Chrysler owners to stream audio books, apple music, turn by turn directions and more directly into audio system and retains use of the optional CD changer in lower dash, trunk or hatch. If vehicles does not have a CD changer, purchase our [BLU-CHR](#) instead.

See **Frequently Asked question** at the end of this guide for more details.

## Installation:

**Alert!** Module connects directly to radio. **CD Changer (required) remains connected and functional.**

Radio removal from dashboard required to gain access to connector. Vehicle specific radio removal is not part of this guide; however, some may be available upon request.

1. Disconnect factory CD changer plug (See **Fig.2**) from radio 8-pin "CD" changer connector (See **Fig. 1**).



Fig. 1

2. Connect factory CD changer plug (See **Fig. 2**), to 8-pin connector on adapter (See **Fig. 3**)



Fig. 2



Fig. 3

3. Connect 8-pin plug from adapter (See **Fig. 2**) to 8-pin "CD" changer connector on radio (See **Fig. 1**)
4. Connect/splice/Tap red wire (See **Fig. 4**) to a 12V accessory (switched) supply wire in vehicle. 12V accessory or switched supply is available on radio harness.

**Warning: Avoid connecting 12V accessory wire to battery (always on) supply.**



Fig. 4

5. Re-assemble dashboard and proceed to "Pairing"

## Pairing:

Pairing process varies between Bluetooth devices but basic steps are the same. This process is done upon initial install and will not have to be repeated.

1. Turn ignition and Radio "ON"  
*LED inside module peephole flashes (pairing mode)*
2. On audio device (e.g. Smartphone): Go to **Settings, Wireless & Networks, Bluetooth Settings**
3. Select **Bluetooth** and turn it "ON" (if not already ON).
4. Select Bluetooth settings
5. Tap **Scan for devices**.
6. Wait for Bluetooth device name (See below) to appear and select it.  
*LED inside module peephole glow steady.*

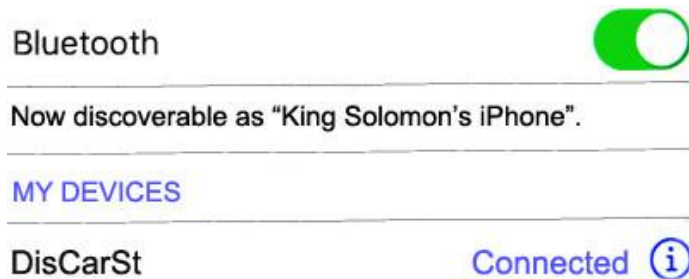

### Note:

*Pair multiple devices (iD) but only one connection is supported.*

## Optional Remote Control:

Purchase optional Smart remote to control music apps on the road or at home. Optional smart remote control allows users to:

1. Keep audio device in pocket, glovebox, purse or elsewhere
  2. To track up/down within playlist etc.
  3. To adjust audio device volume (up/down)
- Warning: Smart remote does not control functions on factory radio.**

## Pairing:

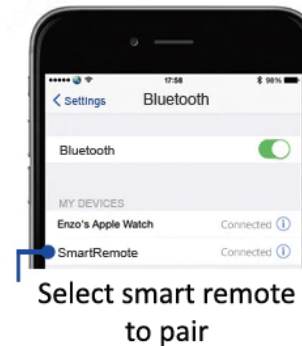
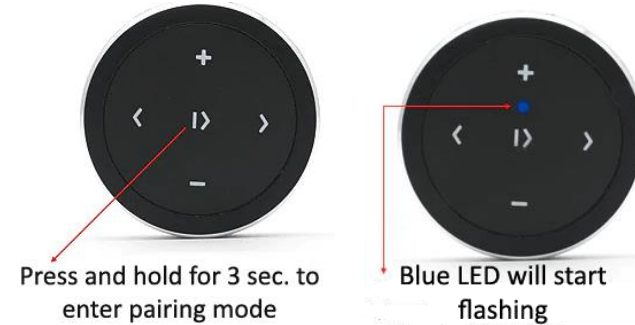

## Operation:

Use wireless remote to perform the following functions on any iOS7.0 and higher or Android 4.4 and higher.

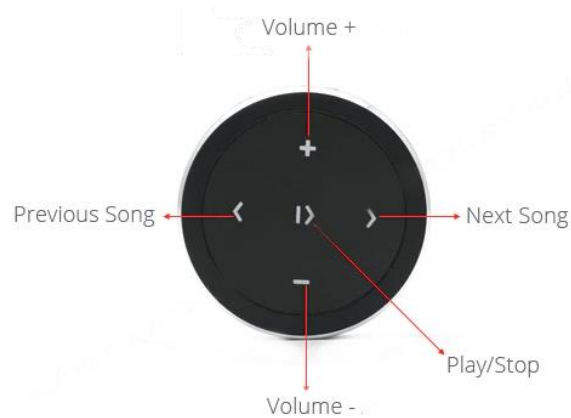

## Package Contents:



Steering wheel holder



battery

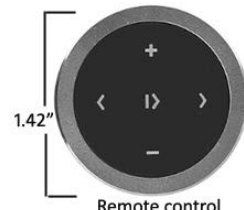

Remote control



Double sided tape

## Test Operation

1. Load at least one Disc in Changer/magazine
2. Turn ignition and radio "ON"
3. Press "MODE" button on radio (Track/Disc number will be displayed)
3. Launch Bluetooth streaming application on audio device
4. Use radio volume control button to set the playback level. If distorted, lower volume on audio device or if inaudible, raise volume on audio device.

**Warning!** Playlist and Track selection is \*NOT\* possible from the Radio. Use smartphone built-in controls to access and control audio files and applications

## To listen to CD's:

- a. Press "MODE" button on radio
- b. **Disable Bluetooth** on audio device. CD Changer playback will resume. (Control changer from radio as customary)

2. To return to wireless streaming:

**Enable Bluetooth** on audio device settings screen.

*Note: Wireless streaming has priority and remains that way until Bluetooth is disabled on audio device. CD Changer Playback is only possible when audio device is not paired to module or is out of range (approx. 30 ft.)*

5. If correct operation is confirmed, tuck away any extra wires and enjoy your new Bluetooth streaming module.

## Frequent asked questions

- 1. How do I switch between streaming and CD Changer playback?**  
The module automatically switches to CD upon un-pairing mobile device. Simply un-pair audio device, press "MODE" button on radio and control CD changer functions as customary. To resume music stream simply pair audio device.
- 2. Will this adapter work on all 1995-02 Chrysler radios?**  
This adapter works on any 1995-02 Chrysler, Jeep, Dodge, Plymouth with remote/external CD changer. CD changer must be in working order for this adapter to work. Some vehicles may include a separate cd changer installed in lower dash while others have the CD changer in trunk/hatch.  
When in doubt check your application [prior to ordering](#).
- 3. Can I control smartphone from radio buttons?**  
**NO;** you must use audio device built-in controls to access music files. Radio volume control is used to set playback level. A safer option is to purchase optional remote control which also helps to keep eyes on the road.
- 4. Can I use the A2D-CHRY to make/receive phone calls?**  
**NO;** The **A2D-CHRY** is for audio streaming and does not support hands-free calls.

### Disclaimer

- This product has no affiliation with Chrysler
- We're not liable for misuse of this product.
- Whenever possible professional installation is recommended.

For additional questions email [support@discountcarstereo.com](mailto:support@discountcarstereo.com)

© 1995-2020-10-16 Discount Car Stereo, Inc. All rights reserved. Information in this document is subject to change without notice. Other products and companies referred to herein are trademarks or registered trademarks of their respective companies or mark holders.