

Courtesy of: DiscountCarStereo.com
Serving the internet community since 1995



Driving without distraction is a necessity for a safer driving experience.

A2D-GM3x

QUICK START MUSIC STREAMING INSTALLATION GUIDE FOR GM CLASS II RADIOS WITH XM MODULE

Created September 15, 2015
Revised February 28, 2022

PRODUCT SAFETY & DISCLAIMER

READ ALL INSTRUCTIONS CAREFULLY BEFORE INSTALLING, FAILURE TO DO SO MAY CAUSE PERSONAL INJURY OR DAMAGE TO PRODUCT AND/OR PROPERTY

- This installation guide is provided as a GENERAL installation guide, some vehicles vary and may require additional steps. We do not accept responsibility for third party labor charges or modifications. Exercise due-diligence when installing this product.
- We do not accept any responsibility for vehicle damage or personal injury resulting from the installation of this product.

Careless installation and operation can result in equipment damage

Requirements

XM TUNER MODULE (U2K) WITH OR WITHOUT SUBSCRIPTION

Introduction

Many 2003-12 GM Class II vehicles were outfitted with XM and may have offered a 1-year free subscription. Many opted to renew subscription while others did not nevertheless the XM module remains installed. If your GM vehicle has an XM module (with or without subscription); the A2D-GM3x makes use of the XM port to input audio from smart device. A Bluetooth connection means no wires, clutter or complicated setup. Simply connect the A2D-GM3x to XM module in remote area of vehicle (trunk, hatch, below glovebox etc.) pair audio device, and enjoy music applications including internet music streaming sites, audiobooks, navigation apps and more. For the A2D-GM3x to work, **vehicle must have XM module** (with or without subscription). If subscribed, service remains uninterrupted. *Simply select subscribed or not subscribed from options on product page and module is then built accordingly.*

See Frequently Asked question at the end of this guide for details.

Installation

Warning: The A2D-GM3x connects at the **XM module in remote location. The plugs do not fit the AM/FM radio.** Purchase our [A2D-GM3](#) or [A2D-CTS](#) (2003-07 CTS/SRX) for connection to the AM/FM radio.

1. Locate vehicle XM module. (See **Fig. 1**)
For help locating XM module, go to the end of this guide.
2. Press black tab to release and disconnect factory 16-pin plug from XM module (See **Fig. 1**)
Note: Vehicles with 16-pin Delphi plug (See **Fig. 2**) must first **pull blue locking tab**, **press black release tab** and pull plug to release. (avoid pulling wires) (See **Fig. 2**)



Fig. 1
XM module



Fig. 2
Delphi 16-pin plug

3. Connect factory 16-pin plug (See **Fig. 2**) removed from XM module in step 2, to harness 16-pin socket (See **Fig. 3**)



Fig. 3
16-pin socket

4. Connect harness 16-pin plug (See **Fig. 2**) to XM socket vacated in step 2.
5. Tap/connect red wire to **12V Accessory supply** in vehicle. Use voltmeter or test light to determine circuit condition to ensure power is only available when ignition key is in "ACC" or "ON" positions. Accessory usually available in vehicle fuse block.

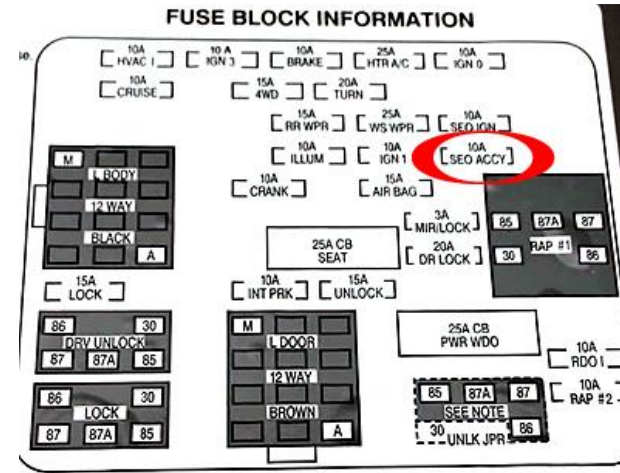

Printed in U.S.A.

WLC 15034213

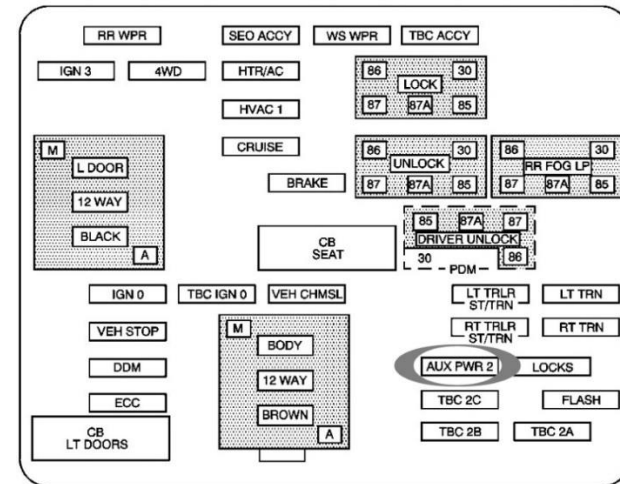

Under no circumstances should red wire be connected to 12V constant

Warning: The A2D-GM3x will not play in RAP (Retaine Accessory Power) mode. Ignition key must remain "ON" in order to stream applications.

6. Secure module and proceed to next section.

Pairing

Pairing process varies among devices but basic steps are the same. This process is done upon initial install and should not have to be repeated.

1. Turn ignition and radio "ON"
Check peephole for flashing LED (pairing mode)
2. Go to device **Bluetooth Settings** and enable **Bluetooth**
3. Tap **Scan (Search) for devices**.
4. Wait for Bluetooth device name to appear and tap:
Subscribers, select **Fig. 4**, non-subscribers **Fig. 5**

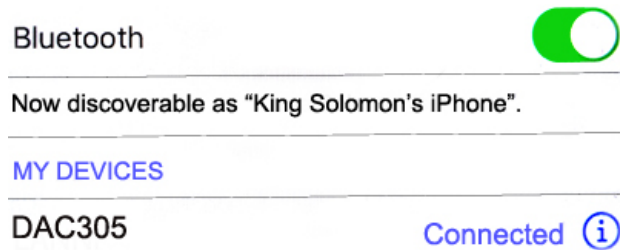

Fig. 4

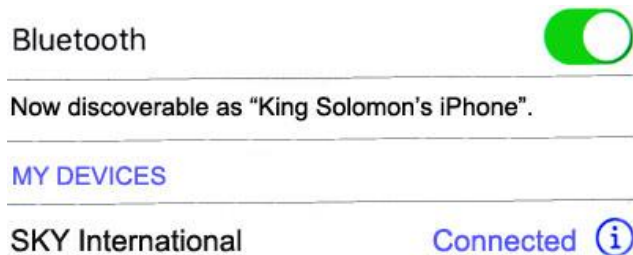

Fig. 5

Note: Some phones allow Bluetooth name change.

Optional remote control

Remote control is not required for operation; however instead of fumbling smart device to change tracks etc., you simply press the familiar control buttons while also keeping eyes on the road. **(Does not control radio functions)**

Optional remote control allows users to:

1. Control music wirelessly
2. Activate VR commands (Google play only)
3. Track up/down
4. Volume up/down

Pairing:

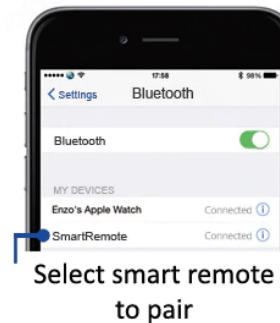

Operation:

Use wireless remote to perform the following functions on any iOS7.0 and higher or Android 4.4 and higher.

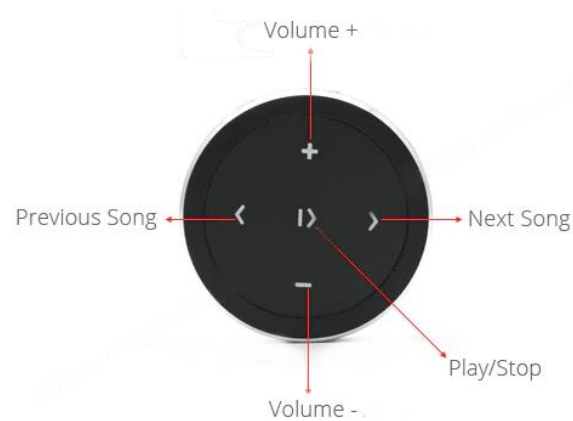

Package contents:



Bluetooth operation

1. Turn ignition and radio "ON"
2. Press "**BAND**" or "**XM**" button to enter XM mode
3. Launch smartphone or tablet streaming application.
4. Smartphone volume should be 80% or higher.
5. Use radio volume control button to set playback level.

Warning: Playlist and Track selection, text display are **NOT** possible from radio. Use audio device built-in controls or optional wireless remote to access and control audio files.

To listen to XM (Subscribers only)

- a. Press "**BAND**" or "**XM**" button on radio to enter XM mode
 - b. Disable Bluetooth on device. XM playback resumes. (Control XM from radio as customary)
2. To return to music streaming:

Enable Bluetooth on A2DP device settings screen.

Note: Music streaming has priority and remains until Bluetooth is disabled on A2DP device. XM Playback is possible when device is not paired, out of range or XM signal is lost.

6. This concludes the installation of the A2D-GM3x. Enjoy!!!

Frequent ask questions and troubleshooting

- My vehicle has a 6-CD changer radio (changer built-into radio), will this work?**
Irrespective of AM/FM radio; vehicle must have an XM Tuner module for the A2D-GM3x to work. XM tuner is a metal box in remote location and is not built-into the AM/FM radio.
- My XM subscription has expired, will the A2D-GM3x work?**
YES; so long vehicle has an XM Tuner module. **See Question 4.**
- I'm not the original owner and don't know if vehicle has XM Tuner module. How can I find out without ripping the car apart?**
Turn radio "ON", press "BAND" or "XM" button repeatedly to cycle through AM/FM/XM. **If only AM/FM is displayed, vehicle does not have the required XM Tuner module. See Question 5.**
- My XM subscription is currently expired, but plan to renew at a later date. Which version of the adapter should I purchase?**
Select "Subscribed", otherwise XM will not play upon activation.
- My radio has a "BAND" button but vehicle does not have an XM tuner; will the A2D-GM3x work?**
NO; Vehicle must have **XM tuner module for A2D-GM3x to work.**
- Can I place hands free calls?**
NO; the A2D-GM3x **does NOT support Hands-Free calls.**
- Why do I have to locate a +12V accessory wire?**
There is no 12V accessory supply at the XM Tuner, therefore one is required for the A2D-GM3x to work as described.
- What's the difference between "Subscribed" and "Not Subscribed"?**
Not subscribed means you no longer have a service plan and do not intend to activate in the future. Subscribed means you have an account or plans to activating at a future date.
- What is the difference between the A2D-GM3x and A2D-GM3?**
The A2D-GM3 connects to the radio and the A2D-GM3x connect to the XM tuner module.

Make	Model	XM Tuner Location
Buick	Allure	Left Rear Q-Panel
	Enclave	Right Rear Q-Panel
	LaCrosse	Behind Rear-Left Q-Panel (Trunk)
	LeSabre	Left Rear Q-Panel
	Lucerne	Left Rear Trunk
	Rainier	Above Pass-side dash Panel
	Rendezvous	Behind Glovebox
	Terraza	Above steering column
Cadillac	CTS	Rear Shelf (Deck) Left Side
	DTS	Left-Rear (Trunk)
	Deville	Behind Rear Seat/Left Q-Panel
	Escalade (EXT/ESV)	Behind Glovebox
	SRX	Behind Rear Right Q-Panel
	XLR	Between Seats
Chevrolet	Avalanche	Behind Glovebox
	Cavalier	Rear Shelf (Deck) center
	Colorado	Behind Glovebox
	Corvette Coupe	Rear Left Q-Panel (above wheel well)
	Corvette Convertible	Between Seats inside hatch cover
	Equinox	Left Rear Q-Panel
	HHR	Rear Right Q-Panel
	Impala	Right Rear Q-Panel
	Malibu	Under Shelf (deck) left Side
	Monte Carlo	Behind Rear Left Q-Panel
	Silverado	Behind Glovebox
	Suburban	Behind Glovebox
	Tahoe	Behind Glovebox
	Trailblazer	Behind Glovebox
	Uplander	Above Steering Column
	Venture	Above Steering Column
GMC	Acadia	Rear Right Q-Panel
	Canyon	Behind Glovebox
	Denali/XL	Behind Glovebox
	Envoy	Behind Glovebox
	Sierra	Behind Glovebox
	Yukon/Denali	Behind Glovebox

Hummer	H2	Behind Glovebox
	H3	Behind Glovebox
Isuzu	Ascender	Behind Glovebox
Oldsmobile	Alero	Right Front Passenger compartment
	Bravada	Behind Glovebox
	Silhouette	Above Steering Column
Pontiac	Aztek	Behind Glovebox
	Bonneville	Left Rear Q-Panel
	Grand AM	Left Rear Q-Panel
	Grand Prix	Right Front Passenger Compartment
	G6	Rear (Trunk)
	G8	Rear (Trunk)
	Montana	Above Steering Column
	Sunfire	Rear Deck (center)
Vibe	Right Rear Q-Panel	
Saab	9-7x	Behind Glovebox
Saturn	Relay	Above Steering Column

Note: These XM tuner locations are to the best of our knowledge and as of the date of the publication. Please verify location in your vehicle prior to ordering.

Disclaimer

- This product has no affiliation with GM.
- We're not liable for misuse of this product.
- We recommend professional installation.

Email support@discountcarstereo.com

© 1995-Feb-22 Discount Car Stereo, Inc. All rights reserved. Information in this document is subject to change without notice. Other products and companies referred to herein are trademarks or registered trademarks of their respective companies or mark holders.