



A2D-HON

BLUETOOTH MUSIC STREAMING INSTALLATION GUIDE FOR SELECT 1992-01 HONDA/ACURA

Created: April 15, 2017

Revised September 14, 2021

PRODUCT SAFETY & DISCLAIMER

READ ALL INSTRUCTIONS CAREFULLY BEFORE INSTALLING, FAILURE TO DO SO MAY CAUSE PERSONAL INJURY OR DAMAGE TO PRODUCT AND/OR PROPERTY

- This installation guide is provided as a GENERAL installation guide, some vehicles vary and may require additional steps. We do not accept responsibility for third party labor charges or modifications. Exercise due-diligence when installing this product.
- We do not accept any responsibility for vehicle damage or personal injury resulting from the installation of this product.
- Careless installation and operation can result in equipment damage.

Requirement

RADIO WITH CD CHANGER CONTROLS

Introduction:

They are literally thousands of older Honda and Acura with original radios in place that unfortunately do not support Bluetooth, but thanks to A2D-HON these radios can be upgraded to support Bluetooth music streaming. Installation could not be simpler and only requires connecting Bluetooth module to the 8-pin CD changer port, pairing Bluetooth device and be on your way to enjoying music, navigation, audio books and other important applications on the car system!

Because this module uses the "CD" port, factory single CD or CD change (if present) must be disconnected.

Installation:

1. Remove radio to gain access to the connector.
(vehicle specific radio removal instructions are not included but available upon request)
2. Disconnect any accessory connected to 8-pin connector (See **Fig. 2**)
3. Connect module 90-degree 8-pin plug (See **Fig. 1**) to radio or slave cassette player 8-pin port (See. **Fig. 2**)



Fig. 1



Fig. 2
8-pin port

4. Reinstall radio.

Pairing:

Pairing process varies between devices but basic steps are the same. Pairing is done upon initial install and will not have to be repeated.

1. Turn ignition and radio "ON"
2. On Bluetooth device: Go to **Settings/Wireless & Networks/Bluetooth Settings**
3. Select **Bluetooth** and turn on.
4. Go to Bluetooth settings
5. Tap "**Scan**" for devices.
6. Wait for Bluetooth device name to appear and select it (see image below)

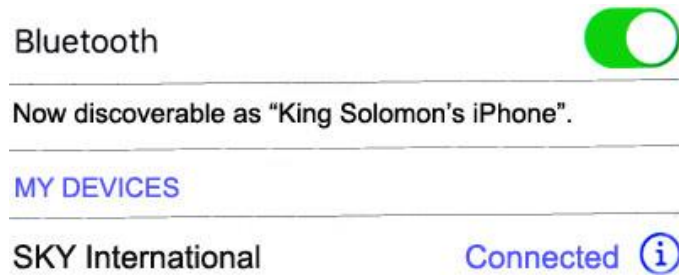

7. Confirmation heard on car speakers

Optional remote control

Wireless remote is not required for module to work as described, however instead of fumbling audio device, you simply press the familiar remote-control buttons while also keeping your eyes on the road.

Optional remote control allows users to:

1. Control music wirelessly
2. Activate VR commands (Google only)
3. Track up/down
4. Volume up/down

Pairing remote control:

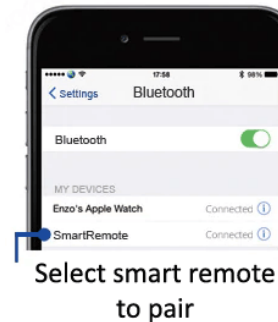
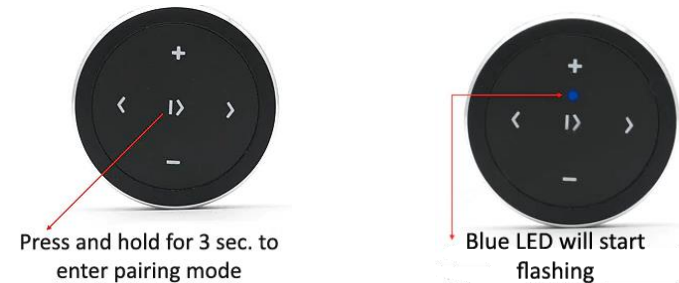

Select smart remote to pair

Operation:

Use wireless remote to perform the following functions on any iOS7.0 and higher or Android 4.4 and higher.

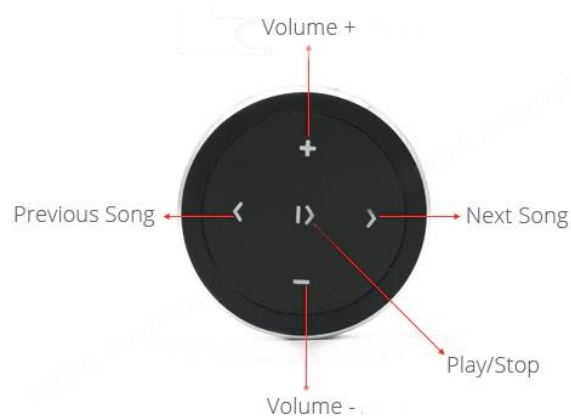

Contents:

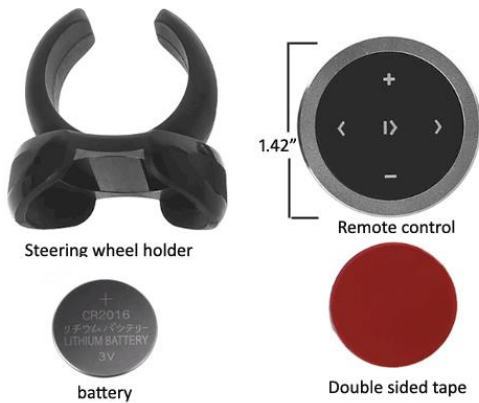

Operation

1. Turn ignition and radio "ON"
2. Press "CD" or "CD/TAPE" button on radio until display changes to CD mode (See Fig. 3)



Fig. 3
CD display mode

Note: If radio does not switch to CD, cycle ignition OFF/ON and try again.

3. Launch smartphone or Tablet streaming application.
4. Use radio volume control button to set playback level and ensure phone volume is at 85% or higher. If playback is distorted, lower volume device or if inaudible, raise volume on both audio device and/or radio.

Warning: Playlist and track selection *NOT* possible from radio buttons. Use smartphone built-in controls and display to access and control audio files and applications.

5. If correct operation is confirmed go ahead and reinstall radio.

Frequently ask questions & troubleshooting

- 1. Does the A2D-HDN work on all Honda radios?**
NO; The A2D-HDN works on select 1992-01 Honda CD changer controlling radios. **(8-pin port and CD button on radio face).**
- 2. My radio has a built-in 6 CD changer, will the A2D-HDN work?**
Most (if not all) Honda **6-CD changer** radios (**changer built-into radio**) do **NOT support** an external device (lacks 8-pin "CD" connector seen in **Fig. 2**) and therefore not compatible. Many Acura 6-CD changer radios DO support external devices. Check for 8-pin DIN connector (See **Fig. 2**) prior to purchase.
- 3. Can I use the radio buttons to control streaming device?**
NO; Use device built-in controls to browse music library.
- 4. Will I be able to make phone calls using this module?**
NO; the A2D-HDN supports music streaming not hands-free calls.
- 5. What happens if a call comes in while streaming?**
Streaming will mute during call and resume upon ending call. Call taken on handset as customary.
- 6. Can I connect module to the CD changer plug in trunk/hatch?**
YES/NO; If vehicle has original CD changer, the module can be connected to CD changer plug, however if an aftermarket cd changer is present, module must be connected to radio.

Disclaimer

- This product has no affiliation with Honda, Acura.
- We're not liable for misuse of this product.
- We recommend professional installation.

email support@discountcarstereo.com