

Courtesy of: DiscountCarStereo.com  
Serving the internet community since 1995



## **A2D-JAG97**

### **QUICK START MUSIC STREAMING INSTALLATION GUIDE FOR SELECT 1986-97 JAGUAR**

Created February 6, 2017  
Revised: September 15, 2021

## PRODUCT SAFETY & DISCLAIMER

READ ALL INSTRUCTIONS CAREFULLY BEFORE INSTALLING, FAILURE TO DO SO MAY CAUSE PERSONAL INJURY OR DAMAGE TO PRODUCT AND/OR PROPERTY

- This installation guide is provided as a GENERAL installation guide, some vehicles vary and may require additional steps. We do not accept responsibility for third party labor charges or modifications. Exercise due-diligence when installing this product.
- We do not accept any responsibility for vehicle damage or personal injury resulting from the installation of this product.
- Careless installation and operation can result in equipment damage.

## Requirements

RADIO WITH CD BUTTON ON FACEPLATE AND 8 PIN PORT

## Introduction

**10/2020 Update: Module for vehicles with CD changer supports Bluetooth 5.0 and Bluetooth 4.2 remain for vehicles without CD changer.**

Portable audio products are everywhere, reflecting demand from active people all over the world to take their music on the road. The A2D-JAG97 provides **Bluetooth music streaming** solution from any A2DP device to allow Jaguar owners to stream audio books, Apple music, turn by turn directions and more directly into audio system via the CD changer port. The A2D-JAG97 is compatible with Jaguar CD changer controlling radios with or without optional CD changer. Vehicles with optional CD changer have the option to retain or disconnect it.

**Dependent on vehicle options, this module is installed at the radio and/or CD changer plug in trunk or hatch.**

**See Frequently Asked question** at the end of this guide for more details.

## Installation 1: To radio

These installation steps apply to connecting module at the radio. Radio removal required to gain access to the "CD" port.

**Warning:** Applies to vehicles without CD changer or if changer is no longer wanted (disconnected or malfunctions). Vehicles with CD connector in trunk or hatch (See Fig. 1), GO to installation 2.

Click [here](#) to remove radio or click link below for dash removal instruction video. XK models differ slightly. <https://www.youtube.com/watch?v=vpAldr6V3iE>

1. Connect module 8-pin plug (See Fig. 2) to radio "CD" input (See Fig. 3)



Fig. 1



Fig. 2

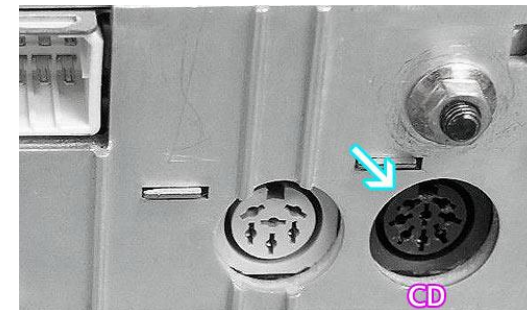

Fig. 3  
Radio "CD" port

2. Re-assemble dashboard and proceed to "Pairing"

## Installation 2- Trunk or hatch

These installation steps apply to connecting module to vehicle's CD changer connector in trunk or hatch. Radio removal not required.

**Warning:** Applies to vehicles with 8-pin CD connector in trunk or hatch, CD changer (if present) must be disconnected. If retaining CD changer, GO to installation 3.

1. Connect module 8-pin plug (See **Fig. 2**) to factory cable in hatch or trunk (See **Fig. 1**). CD changer (if present) must be disconnected and will no longer function.
2. Proceed to "Pairing"

## Installation 3- To radio only

These installation steps apply to connecting module at the radio. Radio removal required to gain access to the "CD" port.

**Warning:** Applies if vehicle has a functioning CD changer you wish to retain. If not retaining CD changer; GO to installation 1 or 2 above

Click [here](#) for radio removal instructions or click link below for dash removal instruction video.

<https://www.youtube.com/watch?v=vpldr6V3iE>

1. Disconnect CD changer plug (See **Fig.2**) from radio
2. Connect CD changer plug to module 8-pin connector (See **Fig. 4**)



Fig. 4

3. Connect harness 8-pin plug (See **Fig. 2**) to radio "CD" input (See **Fig.3**)
4. Connect/splice or tap red wire (See **Fig. 5**) to vehicles 12V accessory (switched) supply. 12V accessory available at cigar lighter **Orange/Brown** wire or pin 11 (Light Green/Orange or White/yellow) wire on radio 14-pin power/speaker plug.

**Do not connect accessory wire to 12V battery (always on).**



Fig. 5

5. Re-assemble dashboard and proceed to "Pairing"

## Pairing

Pairing process varies among devices but basic steps are the same. This process is done upon initial install and will not have to be repeated.

1. Turn ignition and radio "ON"  
*LED inside module peephole will flash (pairing mode)*
2. Go to device: **Settings, Wireless & Networks, Bluetooth Settings**
3. Select **Bluetooth** and turn it "ON" (if not already ON).
4. Tap **Scan for devices**.
5. Wait for Bluetooth device name to appear (See below) and tap.  
*LED inside module glow steady.*



*Note: It is possible to pair multiple devices, but only one connection is supported. Pairs automatically with device to which it was most recently connected.*

## Optional remote control

Purchase optional Bluetooth wireless remote to control music apps on the road or at home.

Optional remote control allows users to:

1. Keep audio device in pocket, glovebox, purse or elsewhere
2. To track up/down within playlist etc.
3. To adjust audio device volume (up/down)

### Pairing:

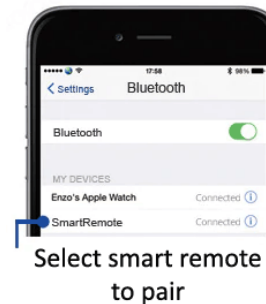
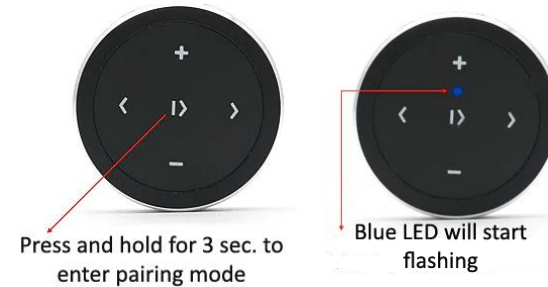

## Operation:

Use wireless remote to perform the following functions on any iOS7.0 and higher or Android 4.4 and higher.

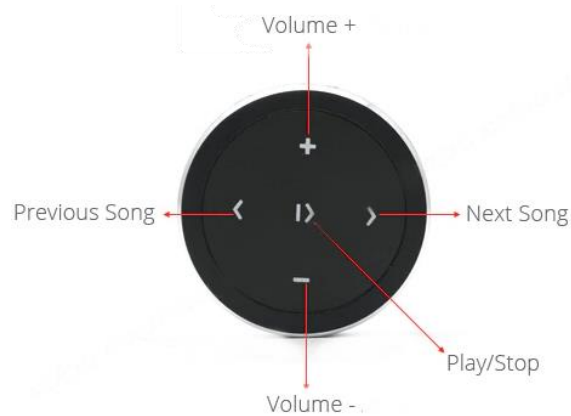

## Package Contents:

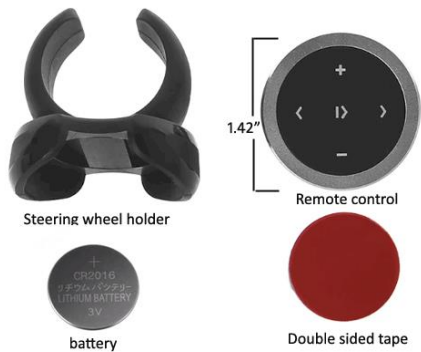

## Operation

1. Turn ignition and radio "ON"
2. If retaining CD changer playback, at least one disc must remain in changer magazine
3. Press "CD" button on radio.
3. Launch streaming application on audio device
4. Use radio volume control button to set the playback level. If distorted, lower volume on audio device or if inaudible, raise volume on audio device.

**Warning:** Playlist and track selection \*NOT\* possible from radio buttons. Use smartphone built-in controls and display to access and control audio files and applications.

## CD playback: (Retaining CD changer)

- a. Press "CD" button on radio  
(At least one disc must be loaded to changer magazine)
- b. **Disable Bluetooth** on audio device. CD playback resumes on car speaker.  
- Control CD from radio buttons as customary.

2. To resume streaming:

**Re-enable Bluetooth** on audio device settings screen. Wait a sec for device to pair

**Note:** Streaming has priority and remains until disabled. CD changer playback is only possible if module is no longer paired or device is out of range.

5. If correct operation is confirmed, tuck away any extra wires and enjoy!

## Frequent ask questions & troubleshooting

- I want to stream from smartphone and retain CD changer. Is this possible?**  
**YES;** if CD changer in trunk or hatch is **functional**, the A2D-JAG97 is able to provide a streaming solution **and also retain CD changer functionality**. When retaining CD changer, the A2D-JAG97 **MUST** be installed at the radio (installation 3) and at least one disc must remain in changer magazine. **WILL NOT WORK IF CONNETED TO CD PLUG IN TRUNK/HATCH.**
- I notice both your A2D-JAG97 and A2D-JAG98 list compatibility with 1997 XK. What's the difference and which should I purchase?**  
An updated audio system introduced in late 1997 XK8 which means vehicles of same calendar year have different audio systems (connectors/plugs). If you own a a late model 1997 XK8, please inspect the CD terminal. Note the two terminals in **Fig. 6**. Ai-NET (right) applies to late 1997 XK8 and requires our [A2D-JAG98](#) 8-pin DIN plug (left), applies to early 1997 XK8 and requires our [A2D-JAG97](#)  
**To avoid costly returns, we ask to check your application prior to ordering.**



**Fig. 6**

8-pin DIN (left) applies to early 1997 XK8

- I purchased option to retain CD changer playback, but how do I switch between streaming and changer playback?**  
The module automatically switches to CD if un-paired. To resume streaming simply enable Bluetooth. **At least one disc must remain in changer magazine otherwise switching may not complete.**
- Why do I pay more for not having or retaining CD changer?**  
In the absence of the changer, the radio "CD" button has no function. In order to activate the CD button, an additional circuit board is required. The additional circuit board enables radio "CD" mode.
- Can I connect the A2D-JAG97 module directly to the radio?**  
**YES;** They're two instances by which users may connect module at the radio:
  - Not retaining CD changer, or vehicle does not have a CD changer or changer malfunctions, disconnected or not wanted.
  - Vehicle has a working CD changer that will be retained
- Can I control smartphone playback from radio buttons?**  
**NO;** you must use audio device built-in controls to access music files. Radio volume control is used to set playback level. A safer option is to purchase optional [remote control](#) which includes most used functions (e.g., track up/down, pause etc.) and helps to keep eyes on the road.

### Disclaimer

- This product has no affiliation with Jaguar
- We're not liable for misuse of this product.
- Whenever possible professional installation is recommended.

For additional questions email [support@discountcarstereo.com](mailto:support@discountcarstereo.com)

© 1995- Sep-21 Discount Car Stereo. All rights reserved. Information in this document is subject to change without notice. Other products and companies referred to herein are trademarks or registered trademarks of their respective companies or mark holders.