

Courtesy of: DiscountCarStereo.com
Serving the internet community since 1995



Mercedes-Benz



A2D-MBR

QUICK INSTALLATION GUIDE FOR SELECT 1994-98 MERCEDES BENZ

Created October 1, 2015

Revised: August 27, 2021

PRODUCT SAFETY & DISCLAIMER

READ ALL INSTRUCTIONS CAREFULLY BEFORE INSTALLING, FAILURE TO DO SO MAY CAUSE PERSONAL INJURY OR DAMAGE TO PRODUCT AND/OR PROPERTY

- This installation guide is provided as a GENERAL installation guide, some vehicles vary and may require additional steps. We do not accept responsibility for third party labor charges or modifications. Exercise due-diligence when installing this product.
- We do not accept any responsibility for vehicle damage or personal injury resulting from the installation of this product.
- Careless installation and operation can result in equipment damage.

Requirement:

CD CHANGER CONTROLLING RADIO

Introduction

Just because you drive an older car does not mean you have to settle for old technology. In order to stay up to speed with fast changing technology, many Mercedes owners have opted to change the factory radio in favor of one that offers modern features such as Bluetooth, navigation etc. but those adamant about keeping their cars as original possible, we offer the A2D-MBR. With a smartphone plus A2D-MBR; users may upgrade factory radio in select 1994-98 Mercedes Benz to support many features offered by aftermarket radio including music streaming, navigation, audio books, and more. Simply connect module to 10-pin CD changer port behind radio, pair Bluetooth device (e.g., Smartphone, iPad, Tablet, Kindle etc.) and enjoy those application on the car speaker system! Installing the A2D-MBR means optional CD changer (if present), must be disconnected, however; to retain the CD changer, purchase our [A2D-MBRCD](#).

Installation

Installing this module requires radio removal
Remove radio from dashboard to gain access to connectors. A pair of removal tools (See **Fig. 1**) is required to remove radio.



Fig. 1
removal [tool](#)



this radio **does not apply**.



1. Slide tools into slots (straight edge facing away) to detent position. Withdraw radio by pulling outwards on the tools. See **Fig. 2**
Click [here](#) for more detailed radio removal instructions.

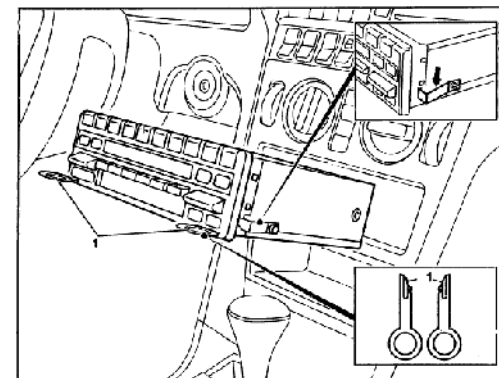

Fig. 2

2. Disconnect factory 10-pin plug (if present) from radio (C) chamber
3. Connect 10-pin plug (See Fig. 3) to radio (C) chamber (See Fig. 4)
4. Factory 10-pin plug (if present) remains disconnected.



Fig. 3
10-pin plug

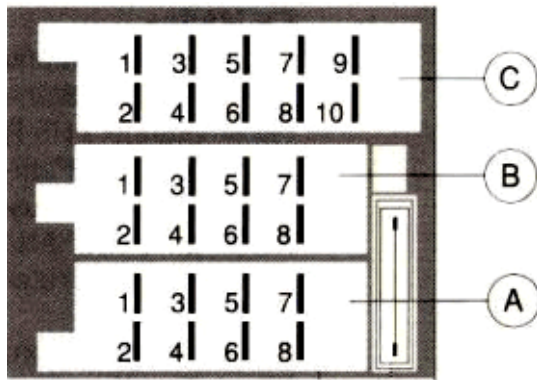

Fig. 4
Radio chambers

Optional remote

This optional wireless remote is not required for the A2D-MBR to work; however, instead of trying to juggle a phone while steering, simply press the remote buttons which can be mounted to steering wheel or dashboard. **Remote does not operate radio functions.**

Remote control functions:

1. Control music wirelessly
2. Switch between sources
3. Track up/down
4. Volume up/down

Pairing remote:

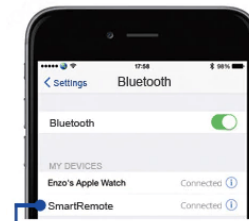

Select smart remote to pair

Remote operation:

Use wireless remote to perform the following functions on any iOS7.0 and higher or Android 4.4 and higher.

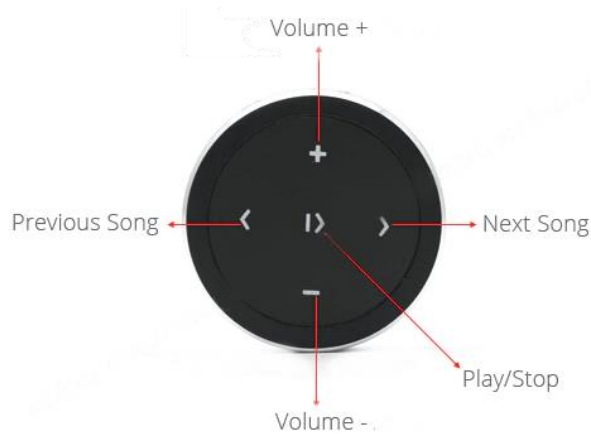

Contents:

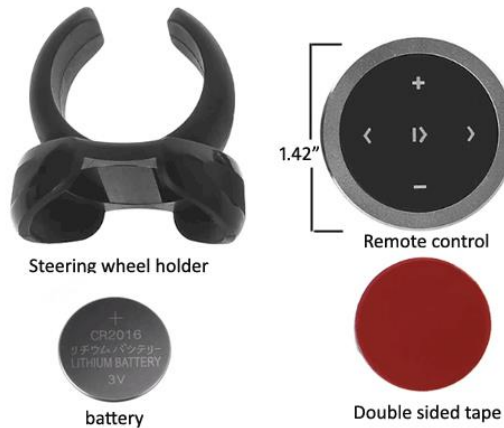

Pairing module

Pairing process varies among devices but the basic steps are the same. Pairing is done upon initial install and will not have to be repeated.

1. Turn radio "ON"
2. On Bluetooth device: Go to **Bluetooth Settings**
3. Select **Bluetooth** and turn on.
4. Tap "**Scan**" or "**Search**" for devices.
5. Wait for device name to appear (Sky International) and select it (See Fig. 5)

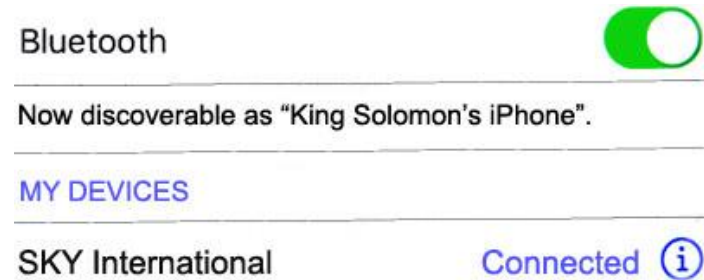

Fig. 5

6. Confirmation tone (connected) will play on car speakers.

Operation

1. Turn ignition and radio "ON"
2. Press "CD" button on radio

Note: If radio does not switch to **CD**, cycle ignition OFF/ON and try again.

3. Launch Smartphone or Tablet music app
4. Use radio volume control button to set the playback level. *Make certain device volume is set 85% or more. If playback is distorted, lower volume on device.*

Warning: Playlist and Track selection is ***NOT*** possible from the radio. You must use the iPod built-in controls to access music files

5. If correct operation is confirmed go ahead and reinstall radio.

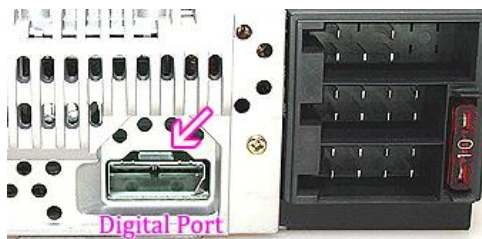

Fig. 6

1999 and Up radios with **digital fiber optic port** **do not apply**

Frequent ask questions & Troubleshooting

1. **Does the A2D-MBR work in vehicles with CD changer?**
YES; but the CD Changer must be disconnected.
2. **Does the A2D-MBR work on all Mercedes radios?**
NO; works on 1994-98 Becker BE1492, BE1692, BE2210, BE1350) Alpine CM2296 and CM2396 radios. (Not for 1999-Up Audio 10, 20, 30, 50 PCM et.)
3. **Can I control Smartphone or Tablet from the radio buttons?**
NO; you must continue to use Smartphone or Tablet built-in controls and display to operate the device or optional wireless remote control. Use volume button on the Becker/Alpine radio to set playback level.
4. **My Mercedes radio also has the 10-pin connector seen in Fig. 6. Does the A2D-MBR work on these radios?**
NO; Mercedes radios with digital port (e.g., Audio 10, 20, 30, 50, PCM etc.) are NOT compatible.
5. **My Blaupunkt radio also has a 10-pin connector. Does the A2D-MBR work on these radios?**
NO; The A2D-MBR applies only to radios listed in question #2.
6. **Will I be able to make phone calls using this module?**
NO; Purchase our [A2DIY-MBCD](#)
7. **What happens when streaming music app and a call comes in?**
Your Bluetooth device will mute music stream. User answers call using handset. Music stream resumes once call ends.
8. **Can I pair or save more than one device to the A2D-MBR?**
YES; more than one device (slaves) can be paired however only one connection can be active at a time.

Disclaimer

- This product has no affiliation with Mercedes Benz, Alpine or Becker
- We're not liable for misuse of this product.

Email support@discountcarstereo.com

© 1995-Aug-21 Discount Car Stereo, Inc. All rights reserved. Information in this document is subject to change without notice. Other products and companies referred to herein are trademarks or registered trademarks of their respective companies or mark holders.