



BTA-TOY03

BLUETOOTH STREAMING INSTALL GUIDE FOR TOYOTA, LEXUS & SCION WITH SIRIUSXM TUNER/REMOTE CD CHANGER

Created: January 15, 2015
Revised: December 8, 2024

PRODUCT SAFETY & DISCLAIMER

READ ALL INSTRUCTIONS CAREFULLY BEFORE INSTALLING, FAILURE TO DO SO MAY CAUSE PERSONAL INJURY OR DAMAGE TO PRODUCT AND/OR PROPERTY

- This installation guide is provided as a GENERAL installation guide, some vehicles vary and may require additional steps. We do not accept responsibility for third party labor charges or modifications. Exercise due-diligence when installing this product.
- We do not accept any responsibility for vehicle damage or personal injury resulting from the installation of this product.
- Careless installation and operation can result in equipment damage.

Requirements:

RADIOS WITH CD", "CD-AUX", "SAT" or "XM" BUTTON ON FACEPLATE

Introduction:

Just because you drive an older car does not mean you settle for old technology. The A2D-TOY03 updates select 2003-12 Toyota/Lexus/Scion radios to support music streaming connection from Smartphone, Tablet, Kindle and more.

The A2D-TOY03 module connects to the radio 12-pin socket which means factory options such as remote CD changer or SiriusXM tuner must be disconnected and no longer function. To retain remote CD changer or Sirius XM functionality; purchase our [BTA-TOY03](#) instead.

After a short pairing session, users are able to enjoy the best sound possible on the car speakers!

See **Frequently Asked question** at the end of this guide for more details.

Installation:

1. Remove Toyota radio from dashboard to gain access to the connectors. (Vehicle specific radio removal instructions are not part of this guide, but available upon request)
2. Locate 12-pin radio socket (See **Fig. 2**). If socket is empty, simply plug-in the module 12-pin plug (See **Fig. 1**) and **proceed to "Pairing" section on page 3.**

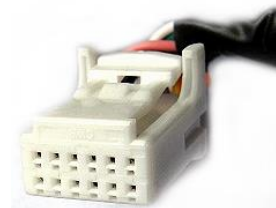

Fig. 1



Fig. 2

If vehicle has XM module or remote CD changer; these will need to be disconnected and will no longer function.

Proceed to pairing.

Pairing:

The pairing process varies among devices but the basic steps are the same. Pairing is done upon initial install and will not have to be repeated.

1. Turn ignition and radio "ON"
 2. From your Bluetooth enabled device, turn the Bluetooth ON and search for Bluetooth devices.
 3. When a list of available Bluetooth devices appears on your Bluetooth device, select "DisCarSt" (See **Fig. 3**)
 4. Confirmation "tone" is heard on car speakers.
 5. The unit will automatically enter the BT Audio source and you can now start streaming audio from your Bluetooth enabled device.
- Note: If the mobile phone doesn't support SSP (Simple Secure Pairing) Profile, please enter the pass code of "0000"

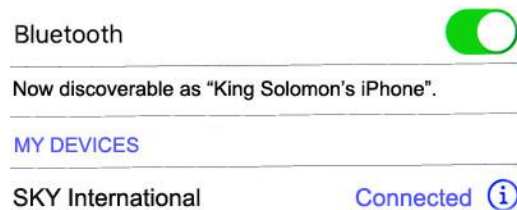

Fig. 3

Optional smart remote:

Smart remote is not required for module to work as described; however instead of fumbling audio device to change tracks etc., you simply press the familiar control buttons while also keeping eyes on the road.

Optional remote control allows users to:

1. Control music wirelessly
2. Activate VR commands (Google play only.)
3. Track up/down
4. Volume up/down

Pairing:

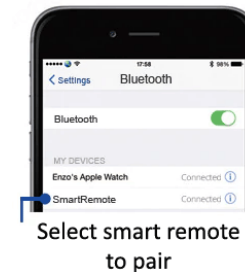

Remote operation:

Use remote to perform the following functions on any iOS7.0 and higher or Android 4.4 and higher.

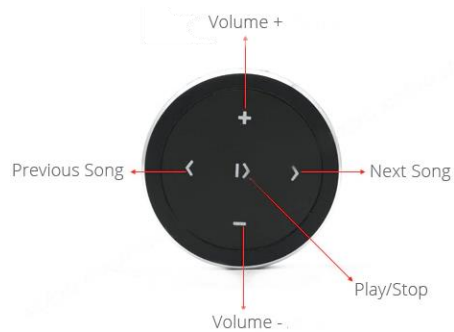

Contents:

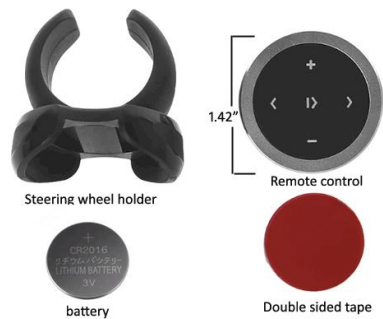

Operation:

1. Turn ignition and radio "ON"
2. Press "CD", "CD-AUX", "SAT" or "XM" button to enter external device mode (See Fig. 4)



Fig. 4

3. Launch smartphone or tablet streaming application.
4. Smartphone volume should be 85% or higher.
5. Use radio volume control button to set playback level.

Warning: Playlist and Track selection, text display are *NOT* possible from radio. Use audio device built-in controls or optional wireless remote to access and control audio files.

This concludes the installation of the A2D-TDY03. Enjoy!!!

Frequent asked questions & troubleshooting:

1. **Will the A2D-TOY03 work in vehicles with a 6-CD changer radio? (Changer built-into AM/FM radio)**
YES; the changer built-into radio will continue to work.
2. **Can I use the A2D-TOY03 to make hands-free calls?**
NO; The A2D-TOY03 support music streaming but **does not** support hands-free-calls.
3. **Will I have to disconnect Satellite radio or separate (external) CD changer?**
YES. Any External device (CD changer, XM radio, rear DVD etc.) must be disconnected and will no longer function.
4. **My vehicle has a SiriusXM module, but subscription has expired (Only able to tune preview channel), will the A2D-TOY03 still work?**
YES. The A2D-TOY03 will work, but SiriusXM preview channel or subscription channels will no longer play. Purchase our BTA-TOY03 to retain SiriusXM or remote CD changer functionality.

* Remote CD changer refers to option installed in lower dash, armrest, hatch, trunk etc. **CD changer built-into AM/FM radio is internal (not external) and remains functional. SiriusXM or rear DVD options must be disconnected.**

Disclaimer

- This product has no affiliation with Chrysler
- We're not liable for misuse of this product.
- We recommend professional installation

Email support@discountcarstereo.com

1995-December 24 Discount Car Stereo. All rights reserved. Information in this document is subject to change without notice. Other products and companies referred to herein are trademarks or registered trademarks of their respective companies or mark holders.