

Courtesy of: DiscountCarStereo.com
Serving the internet community since 1995



PORSCHE



BLU-CR12

QUICK START MUSIC STREAMING INSTALLATION GUIDE FOR PORSCHE WITH CDC-1 AND CDC-2 RADIOS

Created: March 11, 2017

Revised: August 6, 2020

Introduction:

Just because you drive an older car does not mean you have to settle for old technology. Porsche 911, 944, 964, 968, or 993 with a CR-1 or CR-2 radio seeking the ability to stream music, the BLU-CR12 is for you!

The BLU-CR12 music steaming adapter brings these classic vehicles up to speed without sacrificing the radio or dashboard components. Stream Apple music, GPS, audio books and other important applications from Smartphone, Kindle, and Tablet.

The BLU-CR12 works on Porsche CR-1 and CR-2 radios only. CD changer (if present) must be disconnected- to retain use of the CD changer, purchase our [A2D-CR12](#) instead.

Installation:

Remove radio from dashboard to gain access to connectors.

Remove trim ring and ensure the 2 tabs are centered at which point the radio is pulled out the dash (grasping the cassette opening provides some leverage) or push from rear. Proceed with step 1 below:

1. Connect installation harness 13-pin plug (See **Fig. 1**) to radio 13-pin **connector** (See **Fig. 2**)



Fig. 1



Fig. 2
radio connector

2. Connect installation harness 22-pin plug to module 22-pin **connector** (See **Fig. 3**)



Fig. 3

3. Ensure module dip switches (See Fig. 4) **1, 4, 8** are set to ON or down

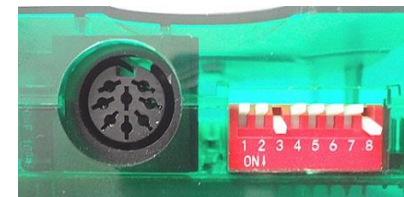



Fig. 4
dip switches

- Route/connect/tap module red accessory wire (See Fig. 5) to a 12V accessory source in vehicle (e.g. fuse box, cigar lighter, etc.)



Red wire must only be connected to suitable 12V accessory supply source in vehicle. Never connect to battery supply (always on) otherwise module will not work as described and risk battery drain

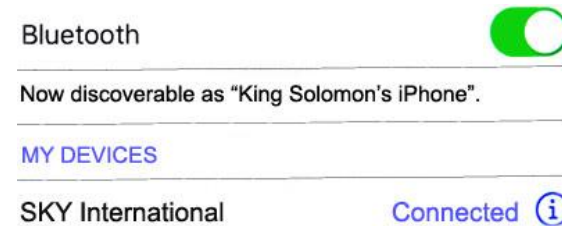

Fig. 5

Pairing:

Pairing process varies among devices but the basic steps are the same. This process is done upon initial install and will not have to be repeated.

- Turn Ignition and radio "ON"
Blue LED inside adapter will flash (pairing mode)
- On A2DP device: Go to **Settings, Wireless & Networks, Bluetooth Settings**
- Select **Bluetooth** and turn on.
- Select Bluetooth settings
- Tap **Scan (Search) for devices**.
- Wait for Bluetooth device name (See below) to appear and select it.
Blue LED glows steady (paired) and tone is heard on car speakers



Optional "Smart remote"

Purchase optional Bluetooth smart remote to control music apps while on the road or at home. (Does not control factory radio functions)

Optional remote control allows users to:

1. Keep audio device in pocket, glovebox, purse or elsewhere
2. Track up/down, pause within playlist etc.
3. Adjust audio device volume (up/down)

Pairing:

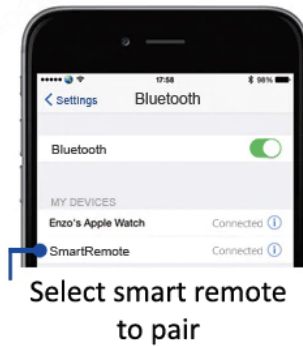

Operation:

Use wireless remote to perform the following functions on any iOS7.0 and higher or Android 4.4 and higher.

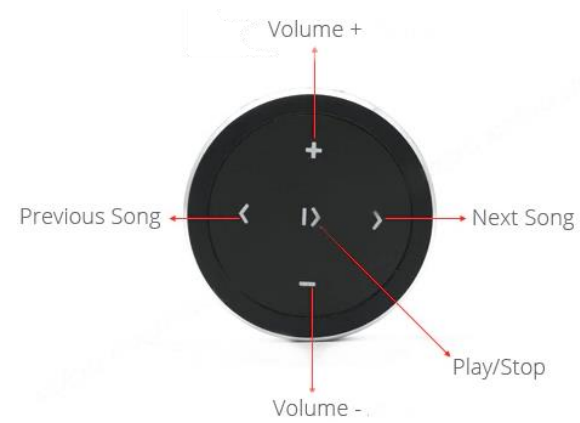

Package Contents:

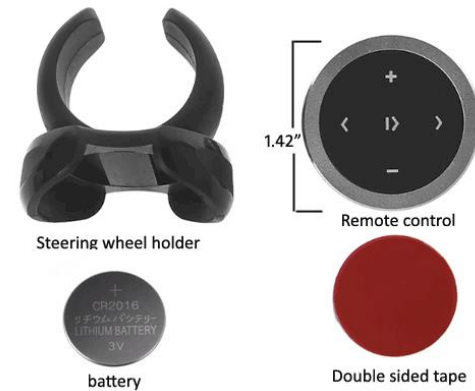

Test Operation:

1. Turn ignition key "ON"
2. Turn radio "ON"
3. Press "CD" button on radio to enter Bluetooth mode
4. Launch audio device (e.g. smartphone) streaming application
5. Set audio device volume to about 80% and radio volume to desired playback level

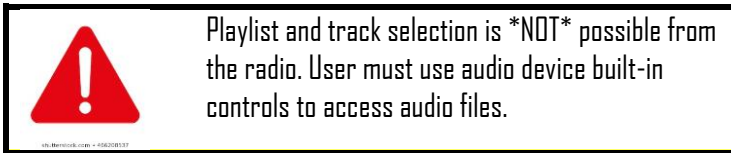

6. If correct operation is confirmed, tuck away any extra wires, reinstall radio and enjoy your new Bluetooth music streaming adapter.

Frequent asked questions

1. **Does the BLU-CR12 work on all Porsche radios?**
NO; The BLU-CR12 works only in Porsche with CR-1 and CR-2 radios.
2. **My Porsche has the optional CD changer, will the BLU-CR12 work?**
The CD Changer must be disconnected for the BLU-CR12 to work. Purchase our [AZD-CR12](#) to retain CD changer functionality.
3. **Can I use the radio buttons to control music streaming device?**
NO; the radio buttons do not control audio device. Use device built-in controls to browse music library or optional "smart remote".
4. **Will I be able to make phone calls?**
NO; the BLU-CR12 does not supports Hands-Free calling
5. **What happens if a call comes in while streaming?**
Music will mute when phone rings at which point you may answer the call using handset. Music streaming resumes as soon as call ends.

Disclaimer

- This product has no affiliation with Porsche etc.
- There are no warranties expressed or implied by purchase of this product
- We're not liable for misuse of this product.
- We recommend professional installation.

Email support@discountcarstereo.com

© 1995-Aug-20 Discount Car Stereo, Inc. All rights reserved. Information in this document is subject to change without notice. Other products and companies referred to herein are trademarks or registered trademarks of their respective companies or mark holders.