

Courtesy of: DiscountCarStereo.com
Serving the internet community since 1995



BLU-CTS

QUICK START INSTALALTION GUIDE FOR CADILLACE CTS/SRX* WITHOUT XM TUNER

created June 10, 2018

Revised: June 10, 2020

Introduction:

If your 1st-generation CTS or SRX audio system did not include U2K package (XM Tuner), chances are you have not been able to find a viable solution for connecting and playing portable audio devices in your car. The BLU-CTS Bluetooth music streaming kit allows these proud owners to stream applications from Smartphone, Tablet, Kindle etc. through the radios XM port.

A wireless connection means no wires, clutter or complicated setup.



This Kit is exclusive to vehicles without XM tuner; however, **factory radio must be XM ready otherwise dealer must activate (turn-on) this feature using a special tool and only then will the radio recognize this module.** Programming (activating) XM is carried out by GM dealer who may or may not charge a fee for the service. **Please call dealer in advance for details.**

2003-07 CTS and 2004-06 SRX with XM Tuner, purchase our [A2D-CTS](#) instead.

See **Frequently Asked question** at the end of this guide for details.

Installation: (To Radio)

Radio must be removed from dashboard to gain access to connectors.

1. Using a panel removal tool, unclip and remove the top A/C vent panel (See **Fig. 1**)

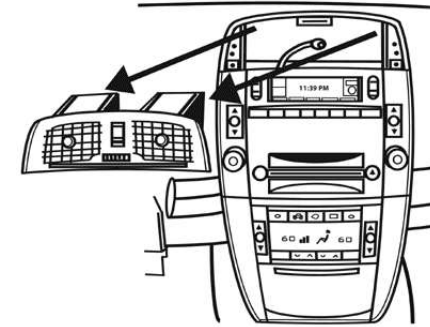

Fig. 1

2. Open ash tray and remove tray. Extract (1) 9/32" (7mm) screw in tray cavity.
3. Using a panel removal tool, unclip and remove A/C control/ash tray assembly below radio (See **Fig. 2**)

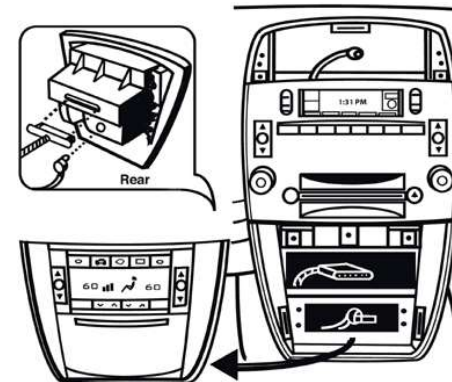

Fig. 2

4. Remove (4) 10mm bolts securing radio to the dash (See **Fig. 3**)

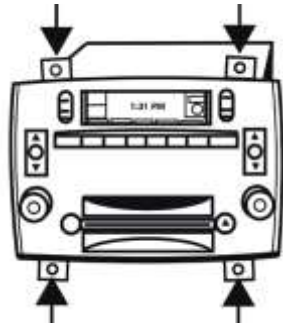

Fig. 3

5. Pull radio forward to reveal wiring (See **Fig. 4**)



Fig. 4

Radio rear view

6. Press release tab on 8-pin gray plug to release from radio (See **Fig. 4**)
7. Connect 8-pin gray plug removed from radio to 8-pin black connector on installation harness (See **Fig. 5**).



Fig. 5

8-pin connector

8. Connect 8-pin black plug from installation harness (See **Fig. 6**) to radio cavity vacated in step 6



Fig. 6

8-pin plug



Fig. 7

radio terminal

9. Disconnect yellow, green and blue plugs from radio and connect all 3 to red connector on installation harness. (See **Fig. 8**)

Note: Some radios may not have all 3 plugs and if so, go to **step 10**



Fig. 8

10. Connect yellow, green and blue plugs from installation harness to radio cavity vacated in step 9.
11. Connect 22-pin Molex plug from installation harness (See **Fig. 9**) to 22-pin connector on green module (See **Fig. 10**)



Fig. 9
installation harness



Fig. 10

12. If not already set, move dip-switch #3 and #8 to "ON" or down (the rest remain OFF or UP) as seen in **Fig. 11**



Fig. 11

13. Turn ignition and radio "ON", and verify **BLUE LED** inside green module is flashing, **otherwise check brown wire for 12V**

Warning:

in 2005 GM modified wiring on CTS radio (Gray plug); however, some late 2004/early 2005 retain old wiring. This change affects audio playback. See Frequent Asked question below for more details.

Pairing:

Pairing varies among devices but the process is same. This step is done upon initial install and will not have to be repeated.

1. Turn Ignition and Radio "ON"
Blue LED inside Module will flash (pairing mode)
2. On A2DP device: Go to **Settings, Wireless & Networks, Bluetooth Settings**
3. Select **Bluetooth** and turn on.
4. Tap **Scan for devices**.
5. Wait for the Bluetooth device name to appear (SKY) and select it.
(See below)
LED will glow steady (paired)

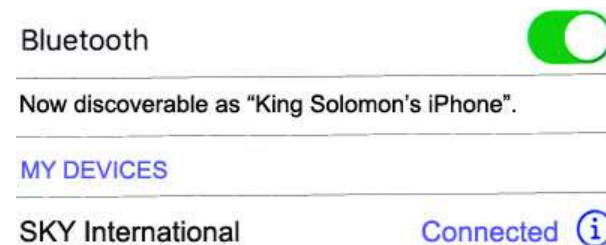

Test Operation:

1. Turn ignition and radio "ON"
2. Press "**BAND**" or "XM" to enter Bluetooth mode
3. Launch Smartphone or Tablet music application.
4. Use radio volume control button to set playback level.

Warning! Use the smartphone built-in controls or optional wireless remote to access and control audio files or applications.

5. If correct operation is confirmed go ahead and reinstall Radio.

Optional Remote Control:

The wireless remote is optional and not required for the BLU-CTS to work, however instead of trying to juggle a phone while steering, simply press the remote buttons which can be mounted to steering wheel.

Remote control functions:

1. Control music wirelessly
2. Track up/down
3. Volume up/down

Pairing Bluetooth remote:

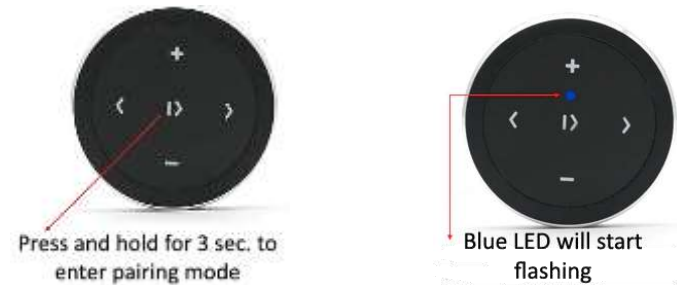

Remote Control Operation:

Use wireless remote to perform the following functions on any iOS7.0 and higher or Android 4.4 and higher.

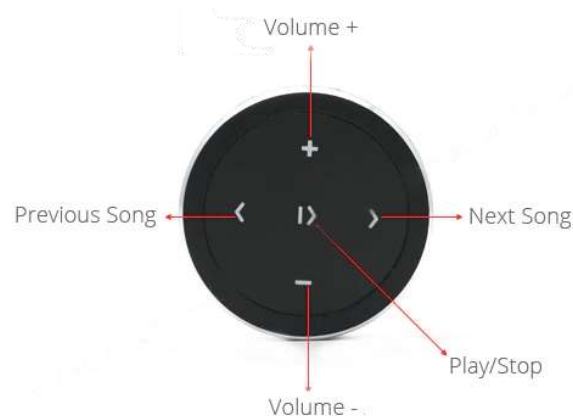

Contents:

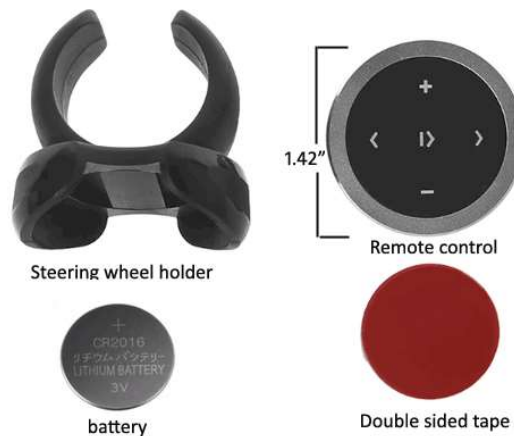

Frequent asked questions

1. Will the BLU-CTS work in vehicles with Navigation?

YES; Works on CTS Navigation but **not for SRX Navigation Radios**

2. I don't know if radio is XM Ready. How can I find out?

For this you are required to visit dealership who can check and/or activate this option for you. Once activated (if not already), the radio will recognize this module. Dealer may charge a fee for activating XM and because of that we recommend contacting dealer for pricing details prior to purchasing this part.

3. In 2005 Cadillac moved the TAN/WHITE wire on gray connector, but we have found some late 2004 models were also affected. If you own a 2004-05 CTS (not applicable to SRX), check wiring on Radio's Gray prior to ordering. Doing so guarantees proper playback and avoids costly returns. Here is how:

if pin 4 is TAN/White (See Fig. 12) select 2003-04 when ordering

if pin 3 is TAN/White (See Fig. 13) select 2005-07 when ordering

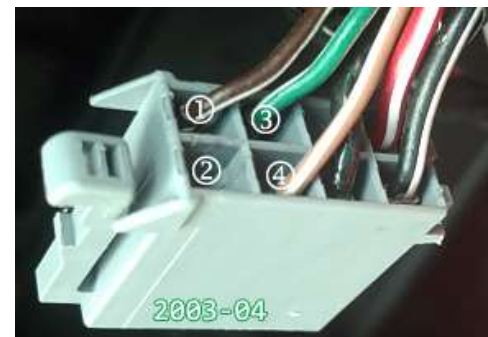

Fig. 12



Fig. 8

Failure to check gray plug (2004-05 CTS) could result in audio playback on right channel only

5. **Can I install this module without removing the radio?**
NO; this module fits only the plugs on the radio. Alternate products include our **A2D-GM3x** which connects to XM Tuner Module on rear shelf (CTS) and side quarter panel (SRX). Vehicle must have XM Tuner (U2K) package for the [A2D-GM3x](#) to work.
6. **Will I be able to make and receive phone calls with the BLU-CTS?**
NO; The **BLU-CTS** supports audio streaming. **Not for hands-free calls.**
7. **Why is this module not compatible with SRX Navigation Radios?**
SRX Navigation radio plugs are different and because of that our BLU-CTS is not compatible. **SRX without Navigation is compatible.**

Disclaimer

- This product has no affiliation with GM
- We're not liable for misuse of this product.
- We recommend professional installation

For help please email support@discountcarstereo.com

© 1995-Jun-20 Discount Car Stereo, Inc. All rights reserved. Information in this document is subject to change without notice. Other products and companies referred to herein are trademarks or registered trademarks of their respective companies or mark holders.