

VOLVO



IL-VOL

QUICK START INSTALLATION GUIDE FOR 1990-01 VOLVO CHANGER CONTROLLING RADIOS

Created March 1, 2017
Revised: September 27, 2021

PRODUCT SAFETY & DISCLAIMER

READ ALL INSTRUCTIONS CAREFULLY BEFORE INSTALLING, FAILURE TO DO SO MAY CAUSE PERSONAL INJURY OR DAMAGE TO PRODUCT AND/OR PROPERTY

- This document is provided as a GENERAL installation guide, some vehicles vary and may require additional steps. We do not accept responsibility for third party labor charges or modifications. Exercise due-diligence when installing this product.
- We do not accept any responsibility for vehicle damage or personal injury resulting from the installation of this product.
- Careless installation and operation can result in equipment damage.

Requirements

CD CHANGER CONTROLLING RADIO

Introduction

Many Volvo Owners with older "SC" and "CT" radios are having a difficult time finding an easy and effective way of connecting and listening to their Apple iOS device. Many are turned away, offered an FM modulator or recommend replacing the radio, but if none of those options pique your interest we offer the IL-VOL. The IL-VOL adapter works in 1990-01 Volvo SC and CT changer controlling radios and only requires disconnecting factory **external CD changer*** (if present), but with the storage capacity of most portable devices, sacrificing the CD changer should be an easy decision.

See more specifics, see frequent ask questions at the end of this guide.

Installation

Radio must be pulled from the dash to connect the adapter.

1. To remove you must first push in on the release tabs at the bottom Left/Right of Radio as seen in **Fig. 1**



Fig. 1

2. Once tabs come out, place index fingers inside release tab ring and pull outward as seen in **Fig. 2**



Fig. 2

3. Connect 8-pin plug (See **Fig. 3**) from adapter harness to "CD" port on radio (See **Fig. 4**).

Factory CD changer (if present) must be disconnected.



Fig. 3



Fig. 4
8-pin CD port

4. Tap yellow wire from adapter to either **GREEN/BROWN** wire on radio harness indicated by yellow arrows in **Fig. 5**

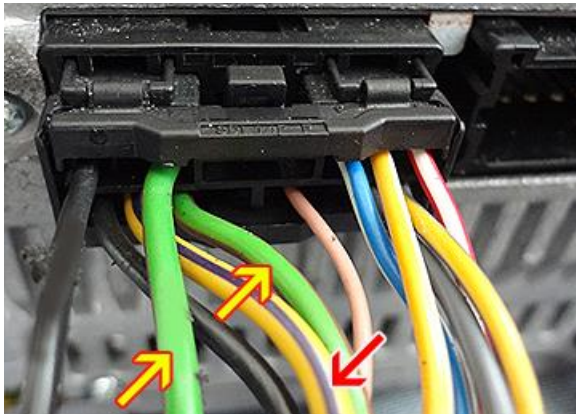

Fig. 5
Radio 14-pin plug

5. Tap installation harness red wire (Accessory) to Yellow/purple wire on "SC" radio harness (See **Fig. 5**)
Note: Other radio harness colors may differ. Please use voltmeter or test light for voltage verification.
6. Run Lightning plug (See **Fig. 6**) to desired mounting location on dashboard, glove box, console etc. (within 4ft. of radio). **Use caution to not cut, pinch or crimp cable during this step.**



Fig. 6

7. Securely install plug and cable in a location away from heat, humidity, moving parts, or sharp metal objects. **Damage to lightning plug may occur if subject to abuse.**

Operation

1. Reconnect battery and enter radio code
2. Turn radio "ON"
3. Press "CHGR" button
4. Connect Apple device to lightning plug
5. Apple device should begin charging
6. Play test track. Track will play on car speakers.
7. Use radio volume control button to set the playback level.

Warning! Playlist and Track selection is ***NOT*** possible from the Volvo radio. You must use the audio devices built-in controls to access audio files

8. If correct operation is confirmed go ahead and reinstall radio

Optional remote

This wireless remote would let you pause, play, adjust volume, or otherwise control your media from farther away than arm's reach. Use at home to control Bluetooth device from up to 30 ft.

1. Keep audio device in pocket, glovebox, purse or elsewhere
2. To track up/down within playlist etc.
3. To adjust audio device volume (up/down)

Pairing:

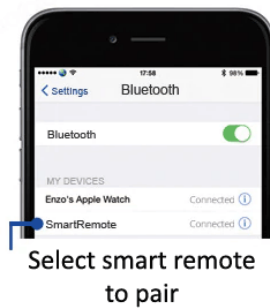
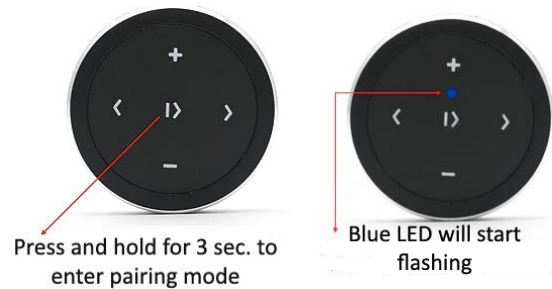

Operation:

Use smart remote to perform the following functions on any iOS7.0 and higher or Android 4.4 and higher.

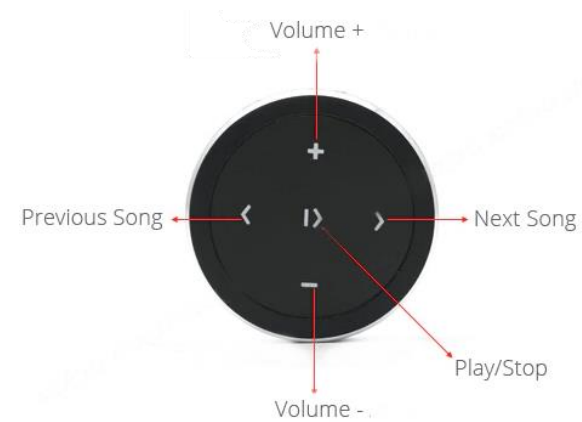

Package Contents:

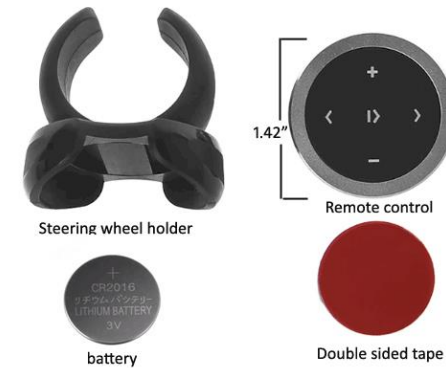

Frequent ask questions & troubleshooting

1. **Does the IL-VOL work all Volvo radios?**

NO; The IL-VOL works only on Volvo "SC" and "CT" radios with CD changer controls such as the "SC-816" pictured below.
(Model number is printed on radio faces)



2. **Can I use radio buttons to control Apple device?**

NO; the IL-VOL is not able to control Apple Lightning device functions. You must use the Apple device built-in controls to navigate its menus or optional [remote control](#)

3. **My vehicle has a factory CD changer in trunk/hatch. Will that continue to play?**

NO; the IL-VOL takes the place of the CD changer (changer must be disconnected)

4. **I've installed everything but my Phone does not charge and audio plays on Phone speaker. Is the unit defective?**

For Apple lightning devices to play or charge, power must be applied to module. Please ensure you did not skip step 4 on page 3. Lastly, if your adapter has a fuse holder, ensure fuse is not blown.

Email support@discountcarstereo.com

1995-2021 Discount Car Stereo, Inc. All rights reserved. Information in this document is subject to change without notice. Other products and companies referred to herein are trademarks or registered trademarks of their respective companies or mark holders.

* External or remote CD changer refers to the optional changer installed under seat, hatch, trunk etc. CD changer built-into the head unit (e.g., SC-901) is not affected